

# Create exceptional workspaces

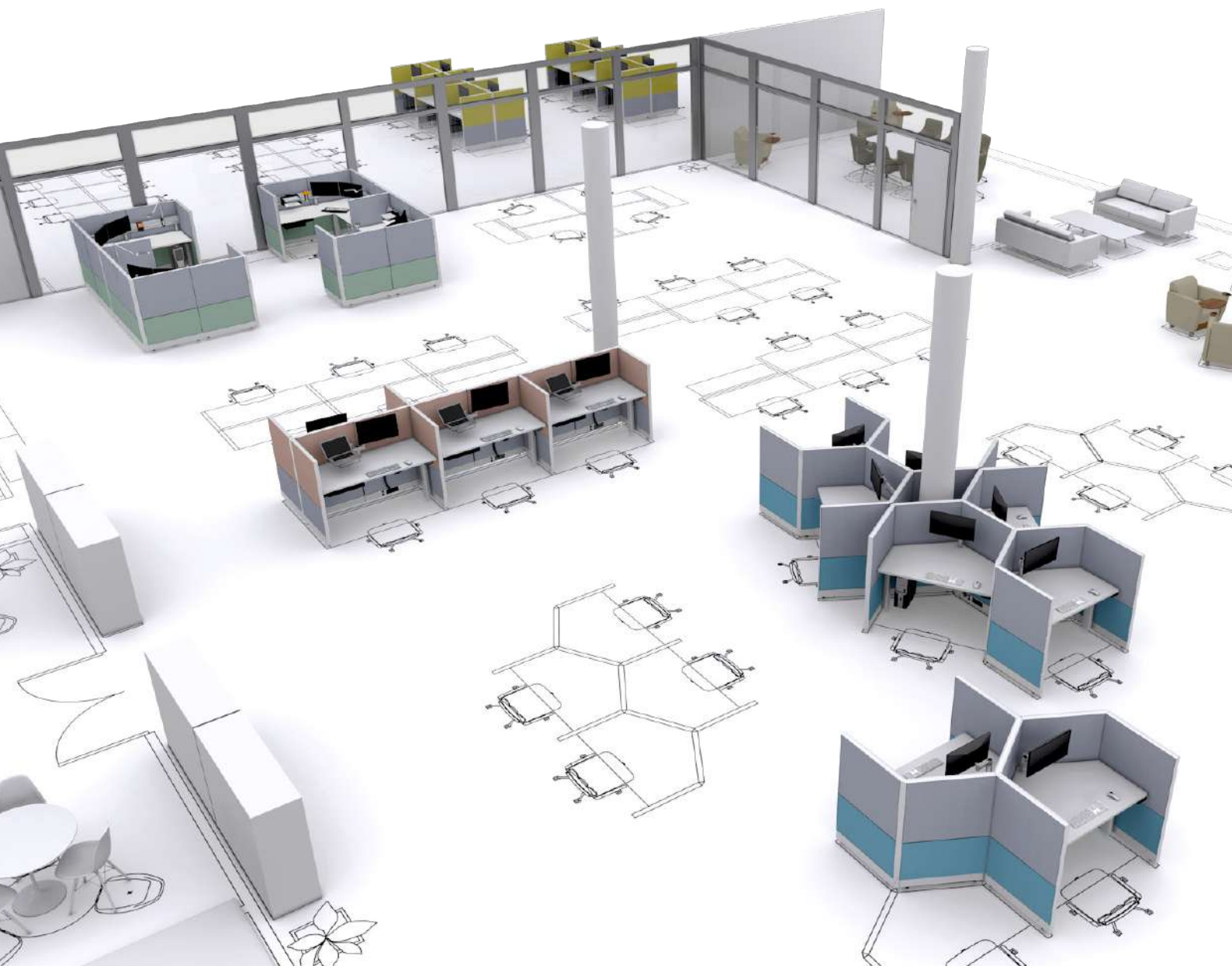



# adapt ergonomics

We are all unique...

Your business is unique, with its own set of goals and challenges, made up of employees with their own individual needs. A well-designed workspace can play a vital role in helping your business achieve its goals.

Whether a task involves deep concentration, working remotely, hot-desking, shift working, agile working or collaborating with other teams, we have solutions to meet your business needs.

## Workspaces that work

The workplace is constantly changing. We've come a long way since the days of big bulky computer monitors, static desks and a 'one size fits all' approach to the way we work. No-one truly knows how workplaces will continue to change and how technology will impact the way we work in the future.

Here at Adapt we're passionate about creating workspaces that work. All of our office furniture and equipment has been ergonomically designed to help your employees perform their activities more efficiently and comfortably.

As no-one knows what the future will bring, all our solutions are scalable and come with a lifetime guarantee, so you can be confident they'll stand the test of time.

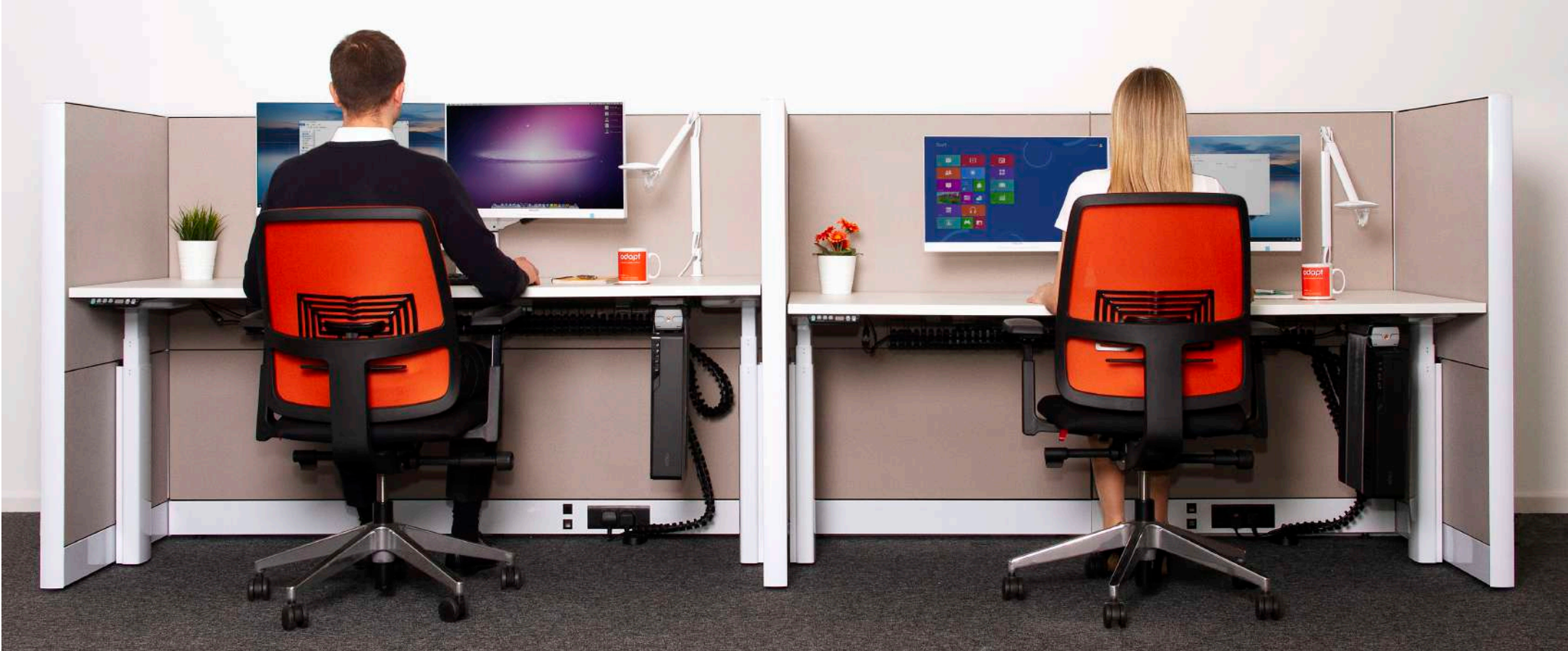



# What can you expect from us?

As a customer, you'll receive high quality products and a personalised, friendly and efficient service, wherever you are.

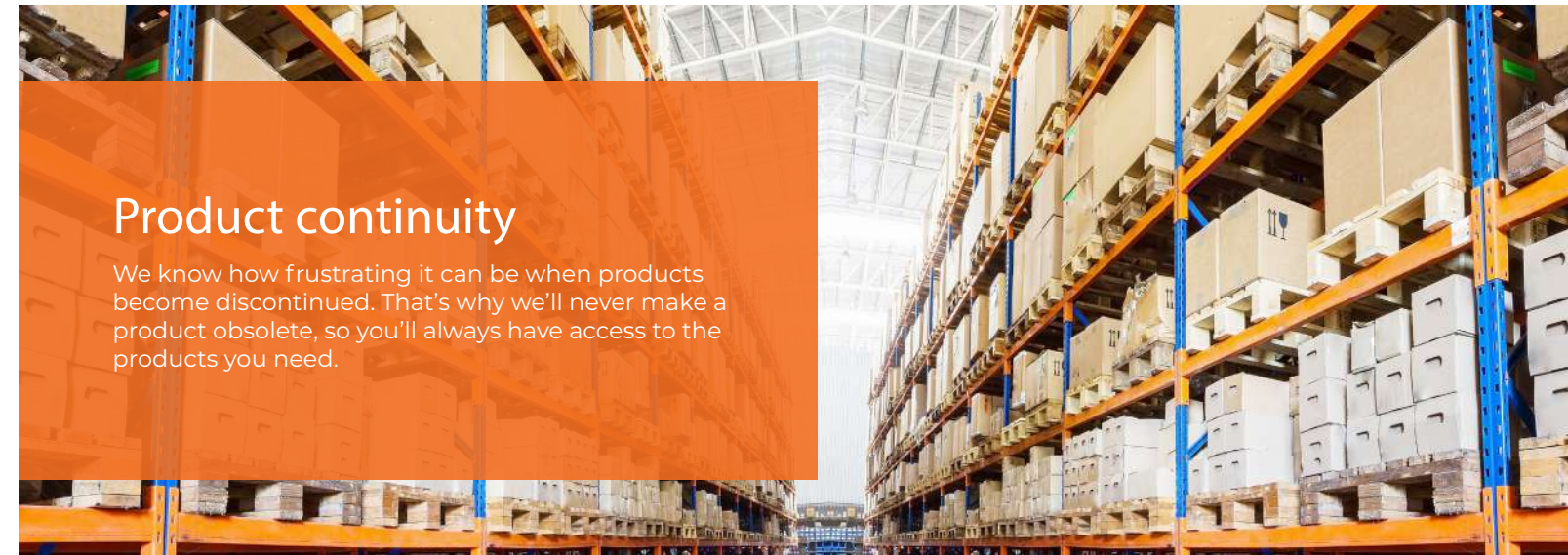

## Product continuity

We know how frustrating it can be when products become discontinued. That's why we'll never make a product obsolete, so you'll always have access to the products you need.

## Future-proof designs

Our office furniture is designed to meet your needs now and in the future. Your products can adapt as your business evolves, offering long-lasting, cost-effective solutions.

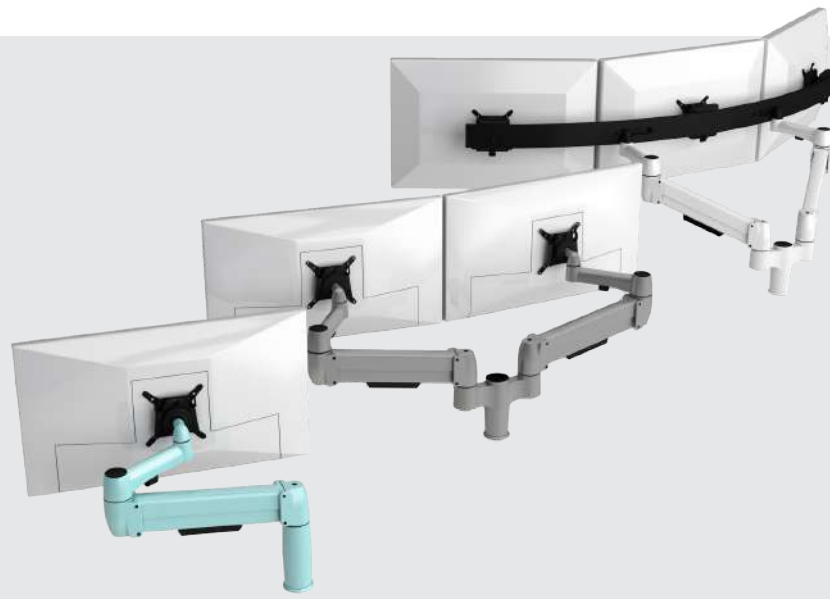

## Customer support

If you're planning a workplace design project, we're on hand to offer expert guidance, support and training to help your project run seamlessly.

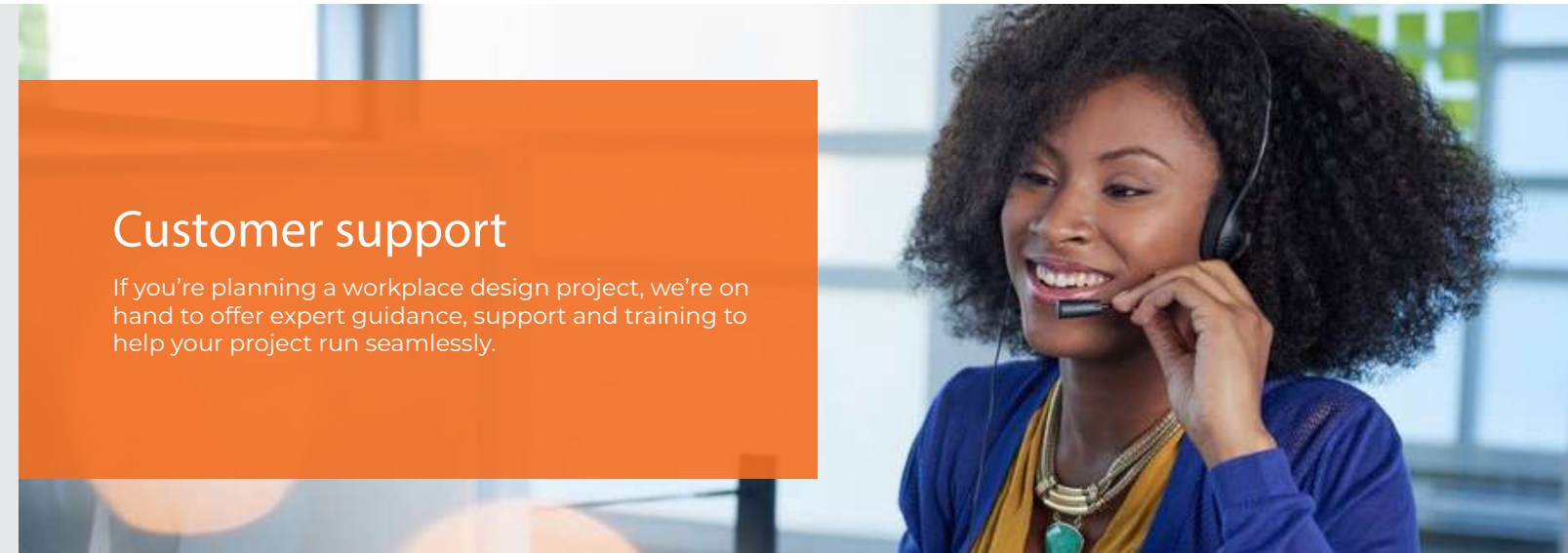

## Customised solutions

We understand that every business is unique. We offer customisation of many of our standard products, to help meet your exact needs.



## Lifetime guarantee

We're proud to offer a Lifetime Guarantee\* on all Adapt manufactured products, giving you peace of mind.

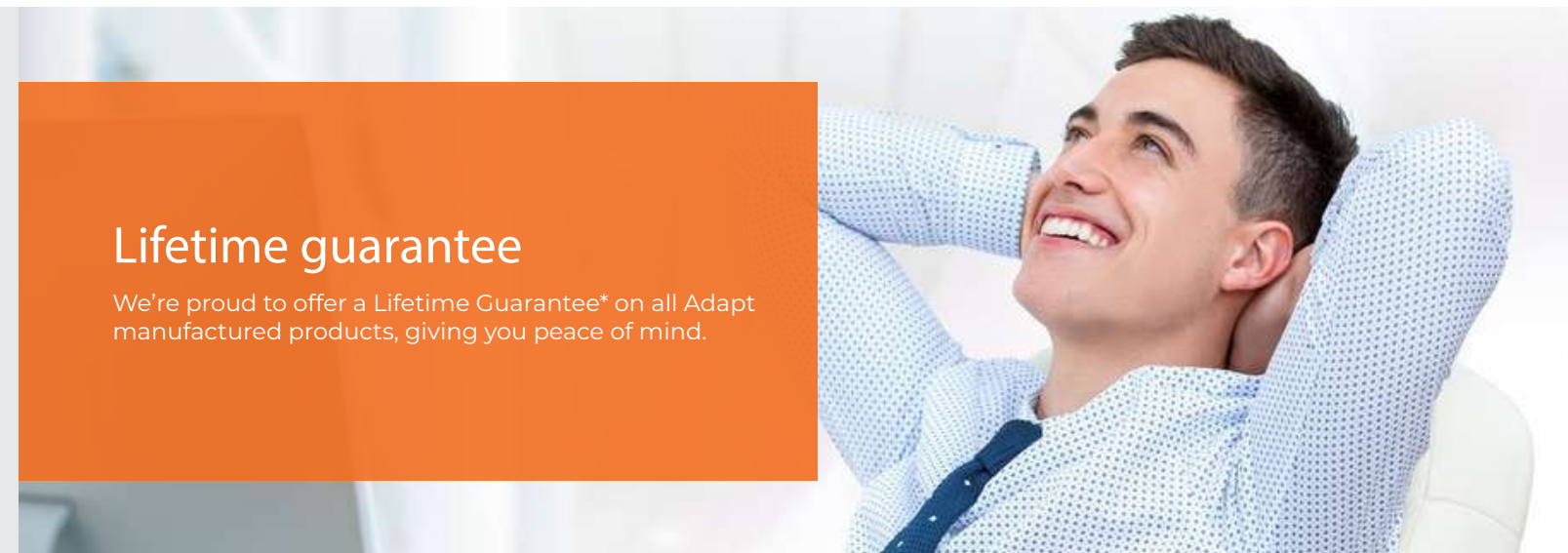

\*Terms and conditions apply



# Product portfolio...

Most of our products can be customised to meet your needs, in terms of size, colour and design.

## Monitor Arms

With their innovative, scalable design, Adapt monitor arms can easily be upgraded from a single arm to a double, triple or even quadruple, giving you the flexibility to meet business demands.

Whether you work from a PC or laptop, we offer solutions and mounting options that put you in control of how you position your monitors.



## Sit-Stand Desks

Our wide range of high-quality, stylish sit-stand desk solutions cater for all budgets. You can choose from small to large straight, corner or 120° desks, with or without acoustic privacy panels. All of our desks can be customised in terms of colour and design to meet your current and future needs.



## Desk Accessories

Our wide range of durable desk accessories are designed to improve different elements of your work experience, from organising your desk efficiently, to ensuring your workspace is well-lit and desk space is maximised.



## CPU Holders

CPU holders lift your PC from the floor, reducing the risk of damage, static and dust build-up, extending the life of your computer and saving valuable desk space. We offer a selection of compact and unobtrusive CPU holders capable of holding up to 15kg, with a range of mounting and bracket options.



## Cable Management

Our cable management range will help clear and organise the chaos from desk to floor, creating easy access to high volumes of cables. Adapt's cable management products can be customised to suit any workspace, including sit-stand desks.



## Desk Power

Adapt's desk power solutions allow you to download data and keep mobiles, laptops, tablets and other technology charged simultaneously. Their space-saving, ergonomic design means you can charge your devices safely and conveniently above the desk.



## Chairs

Adapt offers a variety of ergonomic chairs that can be used in a wide range of environments. Whether you are working individually or want to create collaborative workspaces, our seating will help to promote a flexible, modern working office.



## LED Lighting

Adapt's LED lighting range is highly efficient, reducing your energy costs. Workspaces are correctly lit, helping you to stay focused, alert and productive.





Discover products and solutions to transform your workspace.



Create exceptional workspaces with our ergonomic office furniture solutions.



Ergonomic consultancy and software to improve employee health and productivity.



Solutions to build modern commercial spaces more quickly and efficiently.

To find out more about how we can help your business unlock its potential, please visit our website and contact your nearest office.

[www.adapt-global.com](http://www.adapt-global.com)

